

Level 12/1202/443 Upper Heidelberg Road, Ivanhoe



3



2



2

Breathtaking Skyline Living in the Leafy Suburb of Ivanhoe

Breaking the skyline is this beautifully appointed three bedroom apartment, located on the twelfth floor of the Ivanhoe Apartments. Contemporarily chic with 2.7m ceiling heights and full height glass panel windows and doors inviting the light into the living spaces to showcase the beauty of the deep warm textural and earthy scheme within.

Just a short stroll to The Austin Hospital, Bell St shopping and eateries plus Heidelberg train station.

The galley style kitchen provides plenty of bench-space, ample room for casual dining overlooks the large living area with its own balcony and skyline views. Cabinetry lines the open hallway entrance providing plenty of storage, along with generous robes in each of the twin bedrooms with balcony access through streamlined sliding doors.

Circular basins and mirrors feature in both the bathroom and ensuite with mosaic tiling, elegant tap ware, timber shelves and vanity tops. Each enjoy shower, vanity basin and toilet with the

\$1,250,000

Type: Apartment

Sarah Banachak

0431 418 575

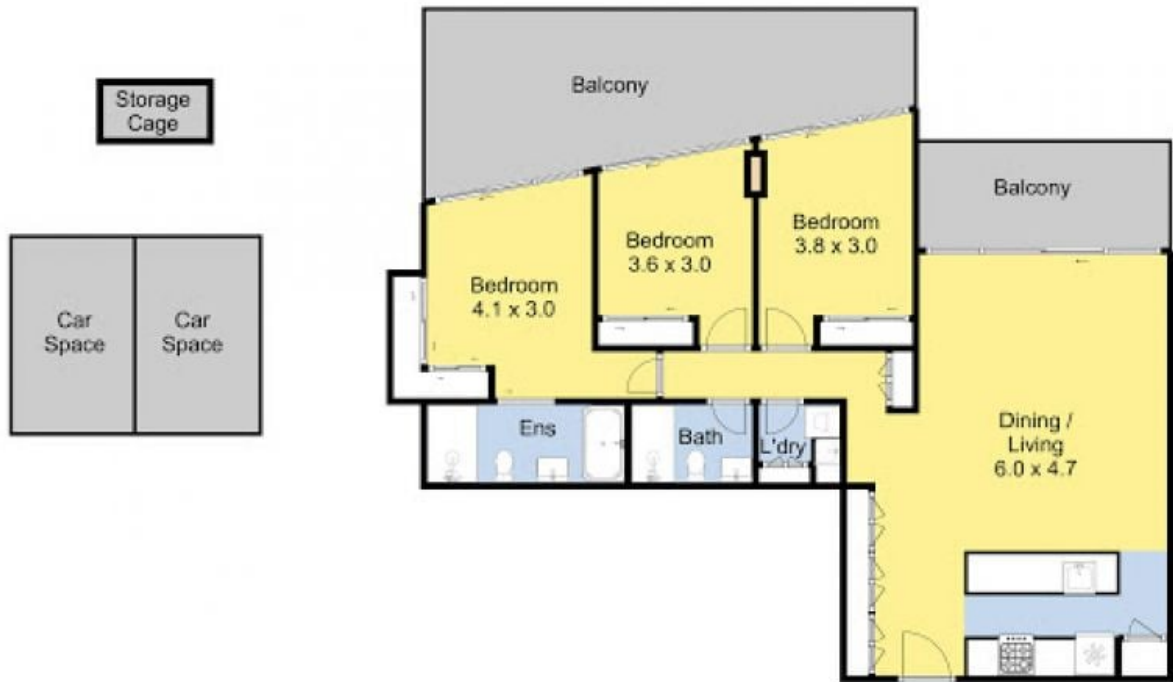

1202/443 Upper Heidelberg Road, Ivanhoe



Disclaimer: Floor Plan measurements are approximate and are for illustrative purposes only. While we do not doubt the floor plans accuracy, we make no guarantee, warranty or representation as to the accuracy and completeness of the floor plan.