



12-14 Phillips Street, Burpengary



4



1



6

Park like grounds just two minutes to Bruce Highway

Golden opportunity to purchase lovingly maintained lowest 4 bedroom brick and tile home, set on a beautifully landscaped private 3000 sqm block, backing onto an open reserve, yet only 2 minutes to the Bruce Highway intersection at Deception Bay taking you to Brisbane or Sunshine Coast.

Enjoy summer in the in-ground pool, amidst the well established gardens, including a variety of Palms, Staghorns, Elkhorns, assorted Fruit/Citrus trees (Mangoes, Mulberry, Fig, Lychee, Banana, to name a few), and Ornamentals (including Camellias, Crepe Myrtles) and Natives.

Year round entertaining will be a breeze in the expansive private wrap around undercover area attached to the house.

FEATURES

Offers over \$1,100,000.00

Type: House
Land: 3000 m2
Carparks: 2

Sarah Banachak

0431 418 575

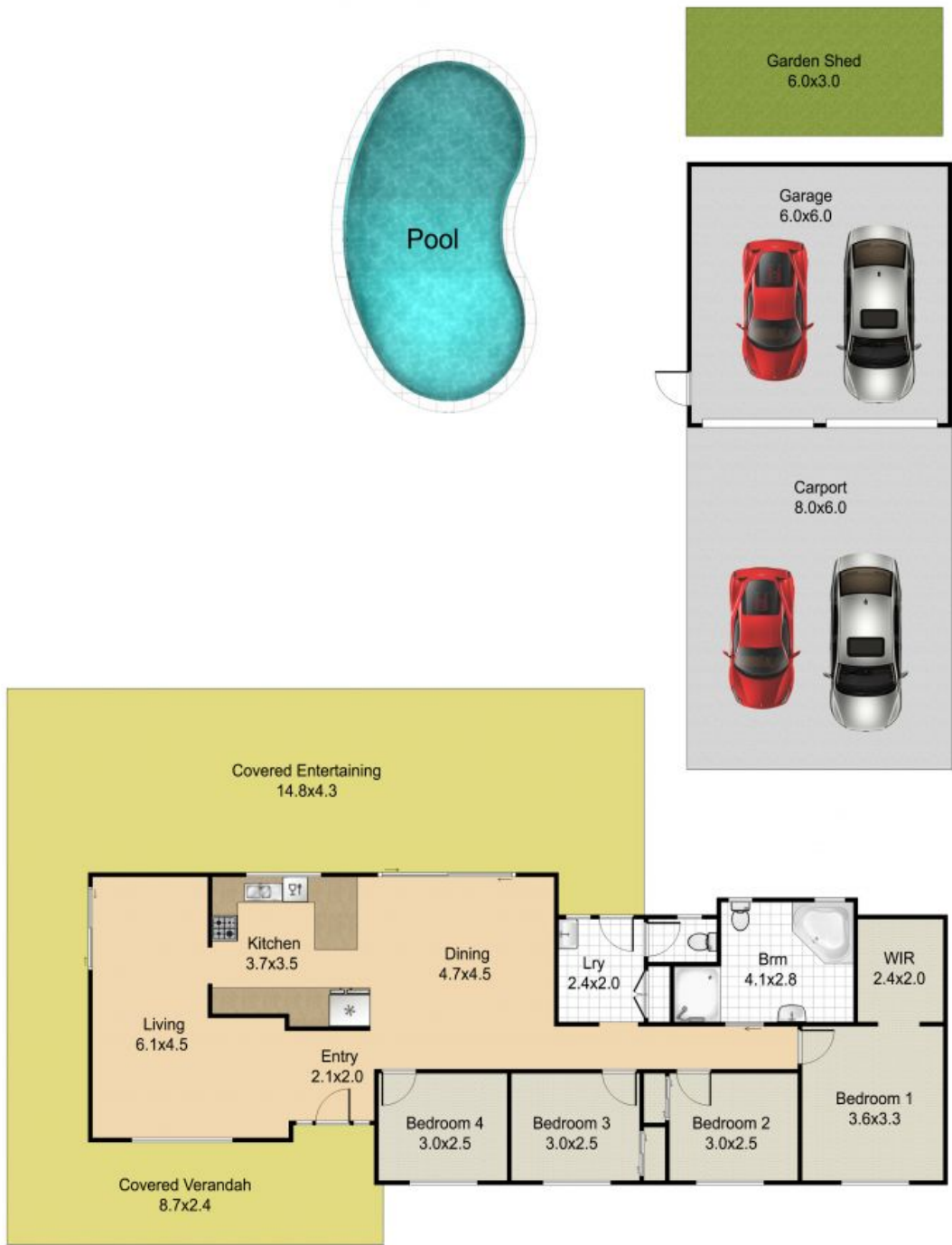

12-14 Phillips Street, Burpengary

APPROX SQM
Internal - 126
External - 202

The floor plan is not to scale; measurements are indicative and in metres. Exterior elements are not in position.
Plans should not be relied on. Interested parties should make and rely on their own enquiries.

12-14 Phillips Street, Burpengary QLD